

CL0205A 10X CCTV LENS SPEC.

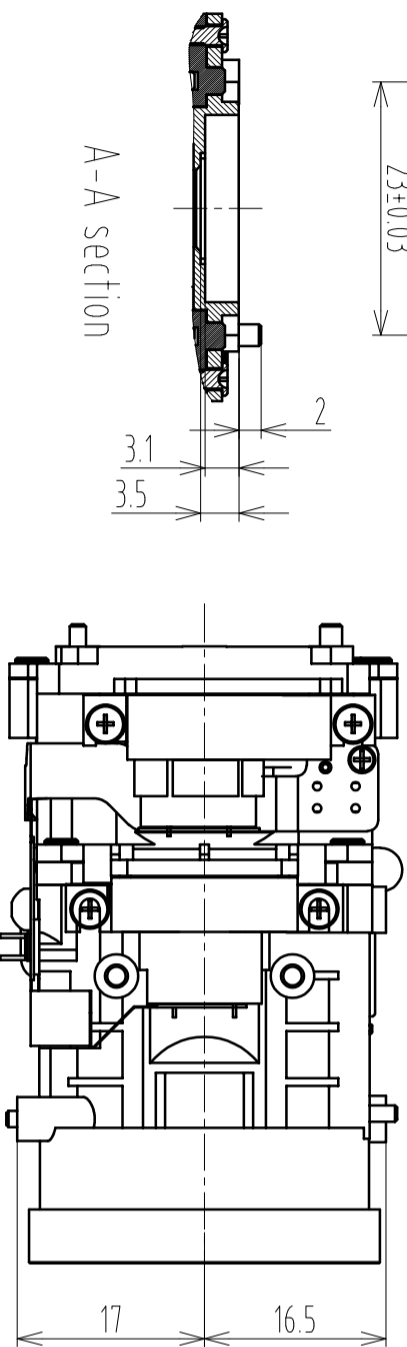
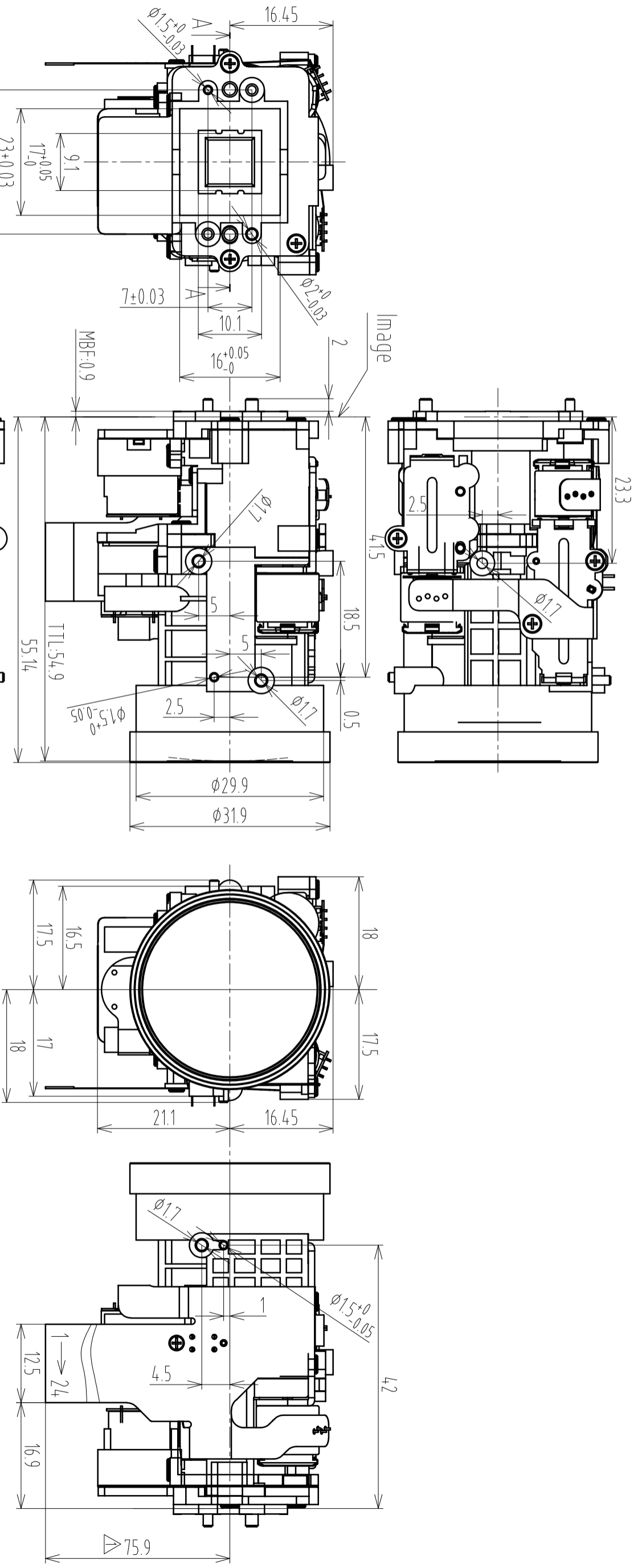

Image sensor	1/3"(CCD or CMOS)	TTL	54.9mm(in air)
Image circle	φ6.7mm	FOV	Wide-D:68°/H:54°/V:31° tele-D:6.7°/H:4.9°/V:4.0°
Lens structure	4 groups 11 glass elements(1 glass Aspherical)	Relative illumination	Wide>4.0%~Tele>4.5%
EFL	5.1(Wide)~5.1(Tele)±5%mm	CRA	Wide<6° Tele<3°
Zoom ratio	10X	IR cut specification	650nm±7nm,wavelength of cut off 50% (With IR cut switch filter)
F/#.	1.6(Wide)~1.8(Tele)±5%,∞	TV Distortion	Wide:-2.0% Tele:1.5% 1 field 3mm
Working Distance(mm)	Wide:0.2m Tele:1m		
BFL	6mm in air		

主要参数

设计	Wei	2013-09-03	名称	10X CCTV LENS	页码	1/1
校对			代号	CL0205A SPEC	版本	V1
审核						
批准						

NO.	Pin Definition	NO.	Pin Definition
1	Zooming Reset P1(Cathode)	13	Focus Motor A +
2	Zooming Reset P1(Emitter)	14	Focus Motor B -
3	Zooming Reset P1(Anode,Collector)	15	Focus Motor A -
4	Iris Cont -	16	Zoom Motor B -
5	Iris Drive -	17	Zoom Motor A -
6	Hall Input +	18	Zoom Motor B +
7	Hall Output +	19	Zoom Motor A +
8	Hall Input -	20	IR CUT Motor +
9	Hall Output -	21	IR CUT Motor -
10	Iris Drive +	22	Focus Reset P1(Anode,Collector)
11	Iris Cont +	23	Focus Reset P1(Cathode)
12	Focus Motor B +	24	Focus Reset P1(Emitter)

TOLERANCE:	LINEARITY TOLERANCES +0.05	三角法	材料(环架)	单位	比例
	ANGULAR TOLERANCES ARE±30°		-----	mm	1:1
	DRAFT ANGLES AREA+0.5°/SIDE				